

CERTIFIED RECORD OF LAND CORNER MONUMENTATION

History of original corner establishment:  
New Corner

\*

DIAGRAM  
T9S R32E  
S1/16  
S321S33

Description of corner evidence found:

Description of monument and accessories I establish to perpetuate the original location of this corner:

Set a 2x28" aluminum monument 18" in the ground in a mound of stone.

T9S R32E  
S1/16  
S321S33  
PLS1918  
1988

I establish new bearing trees:

A 7" P.Pine bears N 65° W, 52.9 ft, scribed S1/16S32BT.  
A 15" P.Pine bears N 70° E, 29.7 ft, scribed S1/16S33BT.

New BTs have 3/4" brass washers marked PLS1918 attached to the BT blaze, faces and bands painted with red tree marking paint, and BT tags and Attention or Land Survey Monument signs. A steel fence post with Attention or Land Survey Monument sign is driven approximately 3-5 feet from the corner.

Sun Cadastral Survey, Cont No. 53-04H1-7-4011  
Field Book: 4-45  
Work accomplished: 9/14/88  
Witnesses: Tyler Parsons, Louise Parsons  
Job No.: 87221

PARSONS SURVEYING  
1915 S.E. Stone Street  
Corvallis, OR 97333  
(503) 752-7515

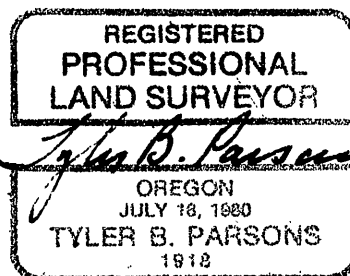

Office of COUNTY SURVEYOR County of GRANT  
State of OREGON, I hereby certify that the within instrument was filed in this office  
for record on the 24th day of Feb, 1989

Robert D. Baggett by \_\_\_\_\_  
(COUNTY OFFICIAL) (DEPUTY)